

**SITE SHOWING THE BOUNDARY AT 260 MOTILAL GUPTA ROAD, KOLKATA - 700008, WARD NO. - 122, BOROUGH NO. - XIII, P.S. - HARIDDEVPUR.**

LAND AREA - 47491.64 SQ.M.

AREA OF GIFTED STRIP LAND - 305.149 SQ.M.

AREA OF GIFTED SPLAYED CORNER - 4.303 SQ.M.

TOTAL AREA OF GIFTED LAND - 309.452 SQ.M.

LAND AREA AFTER GIFT - 47182.188 SQ.M.

NOTE - ALL DIMENSIONS ARE IN MM.

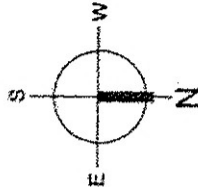
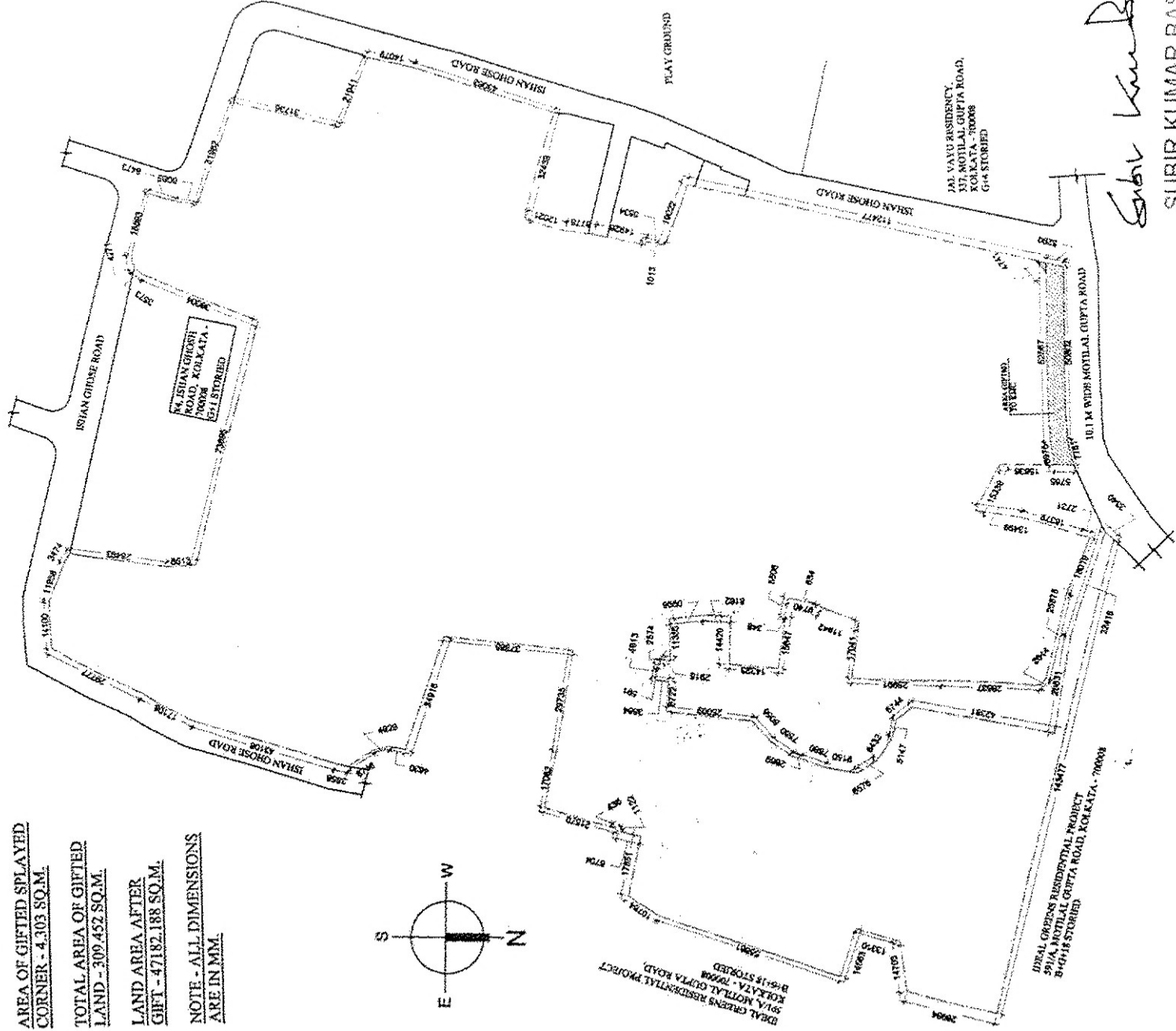

JALSAGAR PROJECTS (P) LTD & ORS.

*[Signature]*  
DIRECTOR/REGISTERED SIGNATORY

SIGNATURE OF OWNER

*[Signature]*  
SUBIR KUMAR BASU

Registered Architect  
Regn. No. - CA178/4375

SIGNATURE OF ARCHITECT